

Hoists and Winches

- Manual Hoists
- Electric Hoists

Lever Hoists

All our lever hoists are manufactured from the highest quality materials precisely machined in our own factory, producing strong products with high resistance to impact damage.

The hoists are finished in our high quality powder coat paint offering excellent corrosion protection. This all ensures they are ideal hoists for long-term use with less maintenance and servicing costs. The strong impact resistant gearbox housing, complete with close tolerance fit bearings that fully support the pinion shaft and planet gears, maintains smooth revolutions whilst under load. High gear ratios keep physical effort to a minimum; this provides maximum mechanical efficiency.

These units meet and exceed all the requirements within BS EN 13157: 2004+A1:2009, ANSI/ASME B30.21, AS1418.2 and SANS 1636.



Industrial TRLH

- Range from 750kg-6.0t
- Drop forged and heat treated alloy hooks
- Safe reliable twin pawl mechanical brake
- High quality alloy calibrated load chain
- Proof tested to 1.5 times rated capacity
- Guaranteed light load protection
- 1.5m height of lift as standard but can be chained to exact requirements
- Optional extra heavy duty chain end stop

Mini Series

- 250kg and 500kg units
- Safe and reliable twin pawl mechanical brake
- Rugged steel body construction
- Lightweight and portable
- 360 degree handle rotation
- Short stroke and low lever pulling effort
- Easy single-hand "freewheeling" operation
- Guaranteed light load protection
- Heat treated alloy steel triple spur gears and pinion shaft
- Operating temperature -40°C to +80°C (temperature range of -60°C to +80°C available as an option)
- Supplied with useful belt bags

Professional PROLH

- Range from 800kg –20.0t
- Patented Quad Cam Pawl System
- DNV GL Verification tested according to NORSOK R-002
- Available with slipping clutch overload protection
- Available with forged clevis adaptor components
- Equipped with our unique torsion brake mechanism
- One piece construction pinion gear
- No requirement for preload tension to activate the ratchet mechanism
- Light load tested and certified at 2% of the rated capacity
- Adaptable to use both inverted and horizontally
- Individual spares readily available
- Operating temperature -40°C to +80°C (temperature range of -60°C to +80°C available as an option)
- All major parts are heat treated and precisely machined
- Finished in high quality powder coat paint offering excellent corrosion protection
- Can be chained up to meet your exact requirements
- Phosphor bronze bearings
- Adjustable chain end anchorage available as an option
- Also available with stainless steel load chain or spark resistant hooks
- Available with load bearing swivel hooks to meet relevant standards i.e. AS 1418.2



UK Network
Rail
PADS
Certification

Industrial TRLH

Product Code	Capacity (tonne)	Effort (kg)	Dimensions (mm)							Load Chain		Standard HOL (m)	Weight @ std HOL (kg)	Weight for extra metre HOL (kg)
			A	B	C	D	E	F1	F2	Diameter (mm)	No. of falls			
TRL-0075	0.75	22	128	240	275	158	99	24	38	6.3	1	1.5	7.5	0.9
TRL-0100	1.0	29	128	240	295	158	99	28	45	6.3	1	1.5	7.5	0.9
TRL-0150	1.5	26	154	360	320	172	104	34	51	7.1	1	1.5	10.0	1.1
TRL-0200	2.0	35	154	360	367	172	104	35	53	7.1	1	1.5	10.5	1.1
TRL-0300	3.0	38	182	360	400	195	108	36	56	10.0	1	1.5	18.0	2.2
TRL-0600	6.0	40	242	360	570	195	108	49	70	10.0	2	1.5	29.5	4.3

Mini Series

Product Code	Capacity (tonne)	Effort (kg)	Dimensions (mm)							Load Chain		Standard HOL (m)	Weight @ std HOL (kg)	Weight for extra metre HOL (kg)
			A	B	C	D	E	F1	F2	Diameter (mm)	No. of falls			
LH-0025	0.25	30	60	168	245	85	66	22	31	4.0	1	1.5	2.0	0.3
LH-0050	0.50	30	89	168	280	113	70	24	38	4.0	1	1.5	3.0	0.3

Professional PROLH

Product Code	Capacity (tonne)	Effort (kg)	Dimensions (mm)							Load Chain		Standard HOL (m)	Weight @ std HOL (kg)	Weight for extra metre HOL (kg)
			A	B	C	D	E	F1	F2	Diameter (mm)	No. of falls			
PLH-0080	0.8	23	128	240	295	158	99	28	45	6.3	1	1.5	7.5	0.9
PLH-0160	1.6	28	154	360	320	172	104	34	51	7.1	1	1.5	10.5	1.1
PLH-0320	3.2	40	182	360	400	195	108	36	56	10.0	1	1.5	18.0	2.2
PLH-0630	6.3	42	242	360	570	195	108	49	70	10.0	2	1.5	28.5	4.3
PLH-0800	8.0	38	379	360	580	195	108	51	78	10.0	3	1.5	43.0	6.5
PLH-1000	10.0	47	379	360	630	195	108	54	87	10.0	3	1.5	46.0	6.5
PLH-1500	15.0	44	566	360	840	195	108	59	81	10.0	5	1.5	112.0	10.8
PLH-2000	20.0	49	470	360	1050	250	160	81	110	10.0	6	1.5	156.0	13.1



Chain Blocks

All chain blocks are manufactured from the highest quality materials precisely machined in the factory, offering a lightweight, compact and rugged construction; producing an exceptionally strong product resistant to impact damage.

The especially low headroom allows for easy installation in the most restricted environments and all units come with drop forged and heat treated alloy hooks. The highly efficient brake systems work instantly when the operation is stopped and securely holds the load. Loads are lowered under perfect control, allowing for precise operations. Tiger chain blocks easily pass the brake lock out test as

per BS 3243:1990 with a 2% load of the rated capacity. PROCB and SS20 are available with forged clevis adaptor components. They can be chained to any height of lift to meet exact requirements and individual spares are readily available. The PROCB/SS20 chain block top hook can be replaced by a competent person so the block can be directly fitted to our beam trolley range of the equivalent capacity achieving the lowest possible headroom.

All chain blocks meet or exceed all international standards within BS EN 13157:2004+A1:2009, ANSI/ASME B30.16, AS1418.2 and SANS 1594.



Industrial TRCB

- Range from 500kg-5.0t
- Safe and reliable twin pawl mechanical brake
- Operating temperature -25°C to +80°C
- Double cover protection for break cover

Professional PROCB

- Range from 250kg-35.0t
- Patented Quad Cam Pawl System
- DNV GL Verification tested according to NORSOK R-002
- Operating temperature -40°C to +80°C (temperature range of -60°C to +80°C available as an option)
- Double cover protection for break cover
- Tested and certified for “fleeting” “drifting” and “cross-hauling” applications up to 45° from the vertical without deration
- Suitable for underground mining use
- Available with slipping clutch overload protection
- Optional chain carrier
- Phosphor bronze bearings

Specialist SS20

- Range from 500kg-35.0t
- All the features of the PROCB as well as the following additional features:
- Suitable for use in multi-immersion applications (see p21)
- Corrosion protected load and hand chain
- Marine specific friction discs
- Marine chain bags available on request
- Fully corrosion protected body and components to ensure reliable long term use
- Stainless steel fixings and fasteners
- New technology high performance grease
- Winged design latches for easier operation
- Ultra-low operating temperature units available



Industrial TRCB

Product Code	Capacity (tonne)	Effort (kg)	Dimensions (mm)								Load Chain		Standard HOL (m)	Weight @ std HOL (kg)	Weight for extra metre HOL (kg)
			A	B	C	D	E	F1	F2	Diameter (mm)	No. of falls				
TRC-0050	0.5	21	93	66	305	52	78	24	38	6.3	1	3	10.5	1.9	
TRC-0100	1.0	25	93	66	340	63	87	28	45	6.3	1	3	11.5	1.9	
TRC-0150	1.5	32	98	73	385	78	102	34	51	7.1	1	3	16.0	2.1	
TRC-0200	2.0	34	101	79	420	87	113	35	53	8.0	1	3	20.0	2.4	
TRC-030T	3.0	34	98	73	488	60	148	36	56	7.1	2	3	23.0	3.2	
TRC-0500	5.0	37	101	79	575	122	209	49	70	8.0	3	3	37.5	5.2	

Professional PROCB

Product Code	Capacity (tonne)	Effort (kg)	Dimensions (mm)								Load Chain		Standard HOL (m)	Weight @ std HOL (kg)	Weight for extra metre HOL (kg)
			A	B	C	D	E	F1	F2	Diameter (mm)	No. of falls				
CB-0025	0.25	17	64	40	240	36	60	22	31	4.0	1	3	3.8	0.5	
CB-0050	0.5	21	93	66	305	52	78	24	38	6.3	1	3	10.5	1.9	
CB-0100	1.0	25	93	66	340	63	87	28	45	6.3	1	3	11.5	1.9	
CB-0150	1.5	32	98	73	385	78	102	34	51	7.1	1	3	16.0	2.1	
CB-0200	2.0	34	101	79	420	87	113	35	53	8.0	1	3	20.0	2.4	
CB-020L	2.0	42	98	73	399	78	102	35	53	7.1	1	3	16.5	2.1	
CB-0300	3.0	38	109	84	500	98	157	36	56	10.0	1	3	30.5	3.2	
CB-030T	3.0	34	98	73	488	60	148	36	56	7.1	2	3	23.0	3.2	
CB-0500	5.0	37	101	79	575	122	209	49	70	8.0	3	3	37.5	5.2	
CB-0600	6.0	38	109	84	635	86	220	49	70	10.0	2	3	45.5	5.3	
CB-0800	8.0	34	109	84	610	153	263	51	78	10.0	3	3	61.0	7.5	
CB-1000	10.0	40	109	84	660	153	263	54	87	10.0	3	3	64.0	7.5	
CB-1500	15.0	41	109	84	840	225	378	59	81	10.0	5	3	128.5	11.8	
CB-2000	20.0	43	161	90	1050	148	360	81	110	10.0	6	3	178.5	14.2	
CB-200T	20.0	43	161	161	1050	383	383	81	110	10.0	6	3	210.5	15.2	
CB-3000	30.0	42	220	220	1200	390	390	91	135	10.0	10	3	307.0	23.8	
CB-3500	35.0	40	240	240	1200	390	390	91	135	10.0	12	3	365.0	27.0	

Specialist SS20 (also used for ROV compatible chain block)

Product Code	Capacity (tonne)	Effort (kg)	Dimensions (mm)								Load Chain		Standard HOL (m)	Weight @ std HOL (kg)	Weight for extra metre HOL (kg)
			A	B	C	D	E	F1	F2	Diameter (mm)	No. of falls				
SCB-0050	0.5	21	93	66	305	52	78	24	38	6.3	1	3	10.5	1.9	
SCB-0100	1.0	25	93	66	340	63	87	28	45	6.3	1	3	11.5	1.9	
SCB-0150	1.5	32	98	73	385	78	102	34	51	7.1	1	3	16.0	2.1	
SCB-0200	2.0	34	101	79	420	87	113	35	53	8.0	1	3	20.0	2.4	
SCB-0300	3.0	38	109	84	500	98	157	36	56	10.0	1	3	30.5	3.2	
SCB-0500	5.0	37	101	79	575	122	209	49	70	8.0	3	3	37.5	5.2	
SCB-0600	6.0	38	109	84	635	86	220	49	70	10.0	2	3	45.5	5.3	
SCB-0800	8.0	34	109	84	610	153	263	51	78	10.0	3	3	61.0	7.5	
SCB-1000	10.0	40	109	84	660	153	263	54	87	10.0	3	3	64.0	7.5	
SCB-1500	15.0	41	109	84	840	225	378	59	81	10.0	5	3	128.5	11.8	
SCB-2000	20.0	43	161	90	1050	148	360	81	110	10.0	6	3	178.5	14.2	
SCB-3000	30.0	42	220	220	1200	390	390	91	135	10.0	10	3	307.0	23.8	

Screw Push Trolley

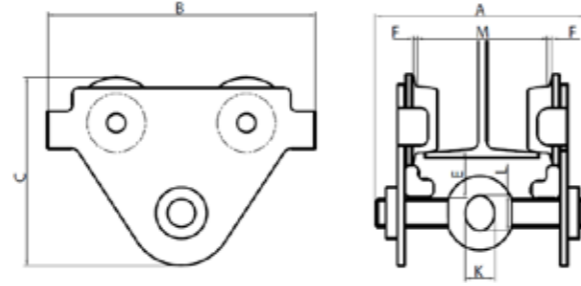

Product Code	Capacity (tonne)	Dimensions (mm)								Min. curve ratio (m)	Net Weight (kg)
		Beam Range M	A	B	C	E	F	K	L		
SPT-0050	0.5	50-220	300	210	190	33	3	25	30	0.9	7.0
SPT-0100	1.0	64-220	300	260	211	31	3	30	35	1.0	10.0
SPT-0200	2.0	88-220	310	310	236	32	3	40	47	1.1	15.5
SPT-0300	3.0	102-220	320	390	295	46	3	48	58	1.3	26.0
SPT-0500	5.0	114-220	330	450	334	47	3	60	70	1.4	38.0

Screw Geared Trolley

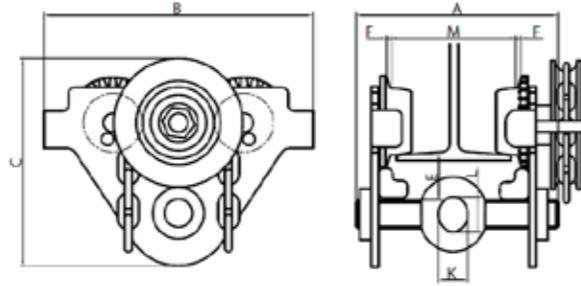

Product Code	Capacity (tonne)	Dimensions (mm)								Min. curve ratio (m)	Net Weight (kg)
		Beam Range M	A	B	C	E	F	K	L		
SGT-0050	0.5	50-220	300	210	190	33	3	25	30	0.9	9.0
SGT-0100	1.0	64-220	300	260	211	31	3	30	35	1.0	13.0
SGT-0200	2.0	88-220	310	310	236	32	3	40	47	1.1	20.5
SGT-0300	3.0	102-220	320	390	295	46	3	48	58	1.3	30.0
SGT-0500	5.0	114-220	330	450	334	47	3	60	70	1.4	45.0

Beam Clamp

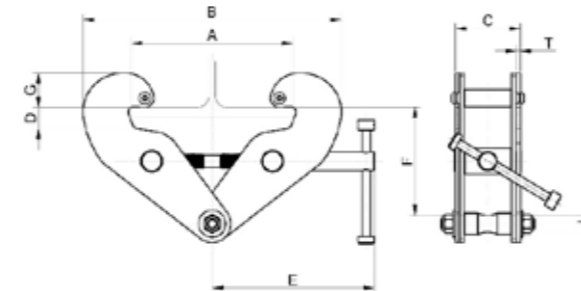

Product Code	Capacity (tonne)	Dimensions (mm)								Net Weight (kg)
		Beam Range M	A	B	C	E	F	G	J	
BC-0100	1.0	75-210	182-328	77	26	190	144-117	52-38	20	4.0
BC-0200	2.0	75-210	182-328	85	26	190	144-117	52-38	20	4.5
BC-0300	3.0	75-305	214-460	107	35	240	224-179	58-40	22	8.0
BC-0500	5.0	75-305	214-460	121	35	240	224-175	58-40	28	10.0
BC-1000	10.0	120-350	295-510	182	36	300	222-171	71-54	43	24.5

Spark Resistant Chain Block



Combined chain blocks and trolleys available

- Stainless steel hand chain (chain blocks)
- Corrosion protected load chain
- Marine specific friction discs
- Brake chamber protection from outside contamination
- Copper plated suspension and load hooks, load chain guides, grip rings, hand wheels and end anchorage

- Stainless steel fixings and fasteners
- Lever hoist also available using our PROLH unit and standard load chain
- Operating temperature -40°C to +80°C (temperature range of -60°C to +80°C available as an option)



Ex II 2 GD c IIC T4 IIC T135°C	
II	2 GD c IIC T4 IIC T135°C
T135°C	Dust Temperature Class: Maximum external surface temperature 135°C
IIC	Groups of Dust: Protected for group IIC which includes groups IIA & IIB
T4	Gas Temperature Class: Maximum external surface temperature 135°C
IIC	Gas Explosion Group: Protected for group IIC which includes groups IIA & IIB
c	Protection type: Design safety
GD	Ex Atmosphere: Gas and Dust
2	Category: High Safety
II	Equipment Group: surface industries



EUROCHAIN VR®
Electric chain hoist for loads from 63 to 10,000kg

Completely innovative, top of the range design, its fluid, contemporary and elegant lines confirm the power of this electric chain hoist.

This new generation of EUROCHAIN VR hoists is the result of innovative technology ; new materials, new operating concepts, can adapt to each specific need.

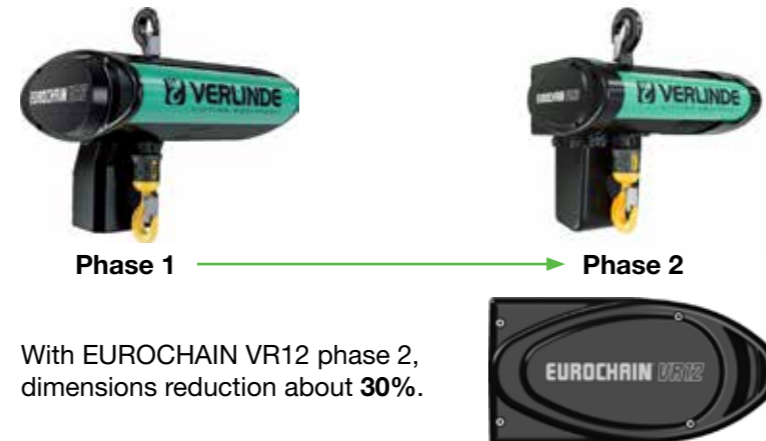

- Optimize and better organization of product offering for EUROCHAIN VR range (VR2, VR5, VR12). Range update with addition of new 2-fall products VR2 (500 kg) and VR5 (1000 kg).
- Better integration of current options (lighting, radio, klaxon,...) compare to phase 1. New options (IP 66 protection, Short headroom trolley,...) will be available on phase 2.
- Product improvements : tilted position of the hoist and size of body reduced by 30% on VR12 (compare to phase 1).

Technical characteristics

The EUROCHAIN VR electric chain hoist is designed to provide users with the maximum level of safety. It is delivered with the following equipment as standard:

- New lifting nut concept with intermediate teeth for perfect chain drive.
- Torque limiter.
- Disk lifting brake.
- 3 m standard lifting height.
- Dual-speed lifting.
- Safety electric end of run for up and down position.
- IP55 lifting and travelling motor.
- Thermal protection on lifting motor.
- Tropic-proof protection (lifting and steering – 90 to 95%).
- Galvanised lifting chain.
- Disconnectable command cable.
- 2-buttons unit on fixed hoist or push steering carriage.
- 4-buttons unit on hoist coupled to electric steering carriage.
- Emergency stop button.
- 400V/3Ph/50Hz or 415V/3Ph/50 Hz or 460V/3 Ph/60 Hz power supply.
- Low voltage 48 V command.
- Chain bag.
- 70 mm, RAL 7021 epoxy powder paint.
- Speed variation on travelling – MS Mode (for hoists with an electric trolley).
- Complies with the CE machine directive.

EUROCHAIN VR5 mounted on VFTS jib crane with EUROSYSYSTEM profile

Speed
Wide range of speeds.

25% quicker than the previous generation: 4/1,3; 8/1,3; 8/2; 10/1,6; 10/2,5; 16/2,7; 16/4; 20/5.

The lifting speed ranges have been considerably expanded to enable them to better meet your production constraints and increase productivity, performance, safety and usage on a daily basis.

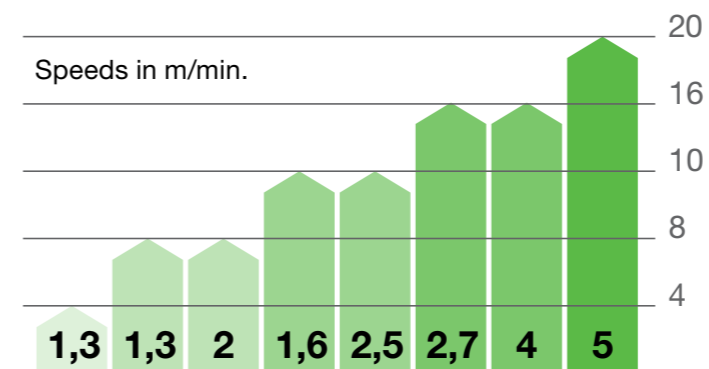
Options available

- Special voltage (power and control).
- Gear limit switches (2 or 4 steps).
- Single phase version.
- Double brake on lifting motor.
- Manual brake release.
- Hard wired 48V control.
- HF radio remote.
- Audible horn.
- Light warning.
- Key switch on Emergency / Stop button.
- Suspension eye perpendicular instead of upper hook.
- Self-locking hook.
- Parallel suspension hook.
- Special oil NSF H1 for food industry.
- Special load for hoist.
- Stainless steel hook block and hook.
- Foot mounted hoist.
- Travel limit switches.
- Low headroom trolley.
- Swivelling trolley.
- Double girder trolley.
- Leading bracket for feeding line.
- Dual speed trolley (20 & 5 m/min).

Savings

Maintenance operations are now simpler, quicker and more economical:

- Easy access to the brake setting.
- Easy access to the clutch setting.
- Easy access to the fuse.
- Access (workspace) and easy removal of the electric boards by removable plug.

EUROCHAIN VR25 for load up to 10,000 kg in combined version



Double brake



Stainless steel wheels



Light warning



Horn



Hard wired control plug



Multipurpose fixing plate



Radio receiver

Taylor-made declination



EUROCHAIN VR5
Fixed suspended by hook.



EUROCHAIN VR25
Fixed suspended by hook.



Hooked to motorized or hand operated trolley in Eurosystem ST profile.



Hooked to motorized or hand operated trolley in Eurosystem ALU profile.



Hooked to hand operated or geared trolley on I beam.



Coupled to motorized trolley on I beam.



Combined hoist for increased capacity up to 10,000 kg coupled to motorized trolley on I beam.



3 falls hoist body for increased capacity up to 7,500 kg coupled to motorized trolley on I beam.



Coupled to short headroom push trolley on I beam.



Coupled to short headroom geared trolley on I beam.



Coupled to swivelling motorized trolley on curved beam.



Coupled to short headroom motorized trolley on I beam.



Coupled to double girder motorized trolley on crane.

EUROCHAIN VR® INOX

Electric chain hoist for loads from 63 to 10,000kg



Technical characteristics

- Stainless steel lifting chain.
- New lifting nut concept with intermediate teeth for perfect chain drive.
- Torque limiter.
- Disk lifting brake.
- 3 m standard lifting height.
- Dual-speed lifting.
- Safety electric end of run for up and down position.
- IP55 lifting and travelling motor.
- Thermal protection on lifting motor.
- Tropic-proof protection (lifting and steering - 90 to 95%).
- Disconnectable command cable.
- 2-buttons unit on fixed hoist or push steering carriage.
- 4-buttons unit on hoist coupled to electric steering carriage.
- Emergency stop button.
- 400V/3Ph/50Hz or 415V/3Ph/50 Hz or 460V/3 Ph/60 Hz power supply.



Options

- Stainless steel lifting hook.
- Biodegradable oil NSF H1 or dedicated for food (lifting and travelling gearbox, lifting chain). Lubricant clean and bubble for chains, sprockets and guides in the industry food. Oil synthetic anti-wear and extreme pressure, usable for incidental contact with the foodstuffs following the FDA requirements (certificates available on request).
- Stainless steel load wheel on trolley hoist and accessory white finish Paint.
- Level of protection increased: ATEX Zone 1, EEx.
- Level of protection increased: ATEX Zone 22.
- IP66 protection.
- Variable speed lifting.
- Extreme operating temperatures: (-40°C to +70°C).
- Wall control panel instead of the pendant.
- Remote radio control.
- Manual or electric trolley.

Hoists dimensions

EUROCHAIN VR2 VR5 VR12

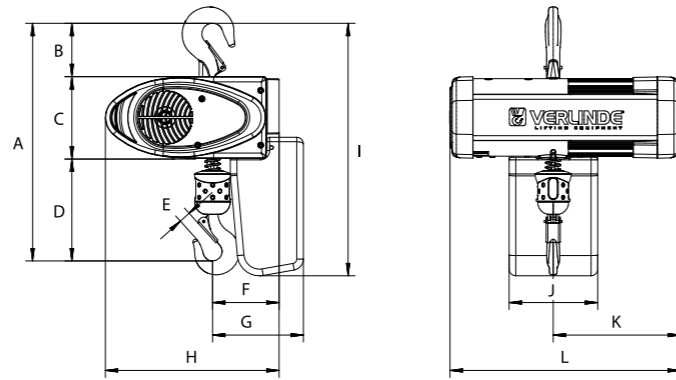

Hoist Type	Chain Dimensions	Chain bag capacity (m)	Max. Loading (kg)	Dimensions (mm)												
				A	B	C	D	E	F	G	H	I	J	K	L	
VR2	4 x 11	8	250	376	86	56	76	186	18	131	300	380	219	230	411	—
	4 x 11	8	500	376	86	56	76	186	18	131	300	380	219	230	411	—
VR5	5 x 14	6/16/25	630	445	107	156	182	21	138	161	362	489/554/674	150	230	438	570
	5 x 14	6/16/25	1000	506	107	156	243	27	123	184	362	489/554/674	150	230	438	570
VR12	7 x 20	6/16/30	1250	537	121	186	230	27	150	205	392	570/711/781	200	287	520	653
	7 x 20	6/16/30	2500	607	121	186	300	33	154	236	392	570/711/781	200	287	520	653

Standard version VARIO version

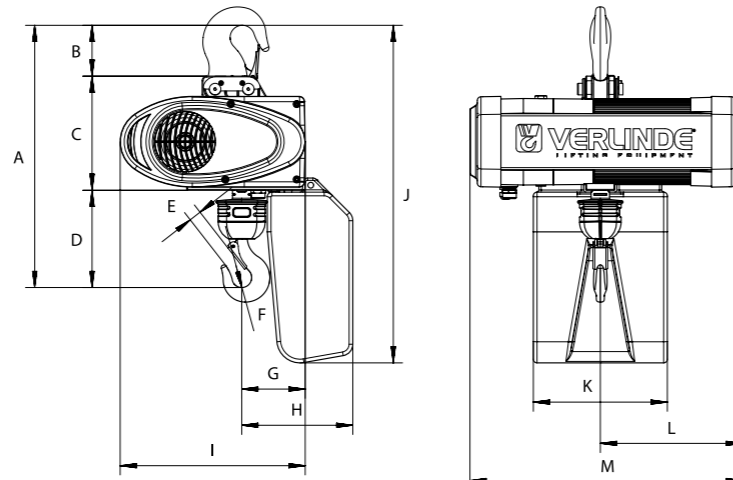

EUROCHAIN VR16 VR25

Hoist Type	Chain Dimensions	No. of falls	Chain bag capacity (m)	Max. Loading (kg)	Dimensions (mm)													
					A	B	C	D	E	F	G	H	I	J	K	L	M	
VR16	7 x 20	1	12	1250	614	110	247	257	28	21	137	240	400	730	290	308	590	
	7 x 20	1	30	1250	614	110	247	257	28	21	137	315	400	905	300	308	590	
	9 x 27	1	12	1600	567	110	247	210	26	22	138	240	400	730	290	308	590	
	9 x 27	1	30	1600	567	110	247	210	26	22	138	315	400	905	300	308	590	
	9 x 27	2	12	3200	693	110	247	336	35	25	179	282	400	730	290	308	590	
VR25	9 x 27	2	30	3200	693	110	247	336	35	25	179	357	400	905	300	308	590	
	9 x 27	1	12	1600	584	110	263	211	26	22	159	286	439	809	300	306	623	
	9 x 27	1	30	1600	584	110	263	211	26	22	159	397	439	986	350	306	623	
	11,3 x 31	1	12	2500	611	110	263	238	33	24	159	286	439	809	300	306	623	
	11,3 x 31	1	30	2500	611	110	263	238	33	24	159	397	439	986	350	306	623	
	11,3 x 31	2	12	5000	761	110	263	388	41	28	207	334	439	809	300	306	623	
	11,3 x 31	2	30	5000	761	110	263	388	41	28	207	447	439	986	350	306	623	
	11,3 x 31	3	nc	6300	nc	nc	nc	nc	nc	nc	nc	nc	nc	nc	nc	nc	nc	nc
	11,3 x 31	3	nc	7500	nc	nc	nc	nc	nc	nc	nc	nc	nc	nc	nc	nc	nc	nc
	11,3 x 31	2 x 2	nc	10000	nc	nc	nc	nc	nc	nc	nc	nc	nc	nc	nc	nc	nc	nc

The EUROCHAIN VR hoist range

Capacity (kg)	Hoist type	F.E.M.	ISO	Lifting speeds (m/min)	No. of falls	HS lifting motor power (kW)	Gear box lifetime (hours)	Chain dimensions	
63	VR2 0608 b3	3m	M6	8 / 2	1	0,45	3200	4 x 11	
	VR2 0610 b3	3m	M6	10 / 2,5	1	0,45	3200	4 x 11	
	VR2 0616 b3	3m	M6	16 / 4	1	0,45	3200	4 x 11	
	VR2 0620 b3	3m	M6	20 / 5	1	0,45	3200	4 x 11	
125	VR2 128 b3	3m	M6	8 / 2	1	0,45	3200	4 x 11	
	VR2 1210 b3	3m	M6	10 / 2,5	1	0,45	3200	4 x 11	
	VR2 1216 b2	2m	M5	16 / 4	1	0,45	1600	4 x 11	
	VR2 1220 b1	1Am	M4	20 / 5	1	0,45	800	4 x 11	
160	VR2 168 b3	3m	M6	8 / 2	1	0,45	3200	4 x 11	
	VR2 1610 b3	3m	M6	10 / 2,5	1	0,45	3200	4 x 11	
	VR2 1616 b1	1Am	M4	16 / 4	1	0,45	800	4 x 11	
250	VR2 258 b2	2m	M5	8 / 2	1	0,45	1600	4 x 11	
	VR2 2510 b1	1Am	M4	10 / 2,5	1	0,45	800	4 x 11	
	VR5 254 b3	3m	M6	4 / 1,3	1	0,9	1600	4 x 11	
	VR5 258 b3	3m	M6	8 / 1,3	1	0,9	800	4 x 11	
	VR5 2516 b2	2m	M5	16 / 2,6	1	0,9	1600	4 x 11	
320	VR5 2520 b1	1Am	M4	20 / 3,2	1	0,9	800	4 x 11	
	VR2 328 b1	1Am	M4	8 / 2	1	0,45	800	4 x 11	
500	VR5 3216 b1	1Am	M4	16 / 2,7	1	0,9	800	4 x 11	
	VR2 504 b2	2m	M5	4 / 1	2	0,45	1600	4 x 11	
	VR5 504 b2	2m	M5	4 / 1,3	1	0,45	1600	5 x 14	
	VR5 508 b2	2m	M5	8 / 1,3	1	0,9	1600	5 x 14	
	VR12 504 b3	3m	M6	4 / 1,3	1	0,9	800	5 x 14	
	VR5 5010 b1	1Am	M4	10 / 1,6	1	0,9	1600	5 x 14	
	VR12 508 b3	3m	M6	8 / 1,3	1	1,8	1600	5 x 14	
	VR12 516 b2	2m	M5	16 / 2,6	1	1,8	1600	5 x 14	
630	VR12 520 b1	1Am	M4	20 / 3,2	1	1,8	800	5 x 14	
	VR5 634 b1	1Am	M4	4 / 1,3	1	0,45	800	5 x 14	
	VR5 638 b1	1Am	M4	8 / 1,3	1	0,9	800	5 x 14	
800	VR12 6316 b1	1Am	M4	16 / 2,6	1	1,8	800	5 x 14	
	VR16 816 b3	3m	M6	16 / 2,6	1	2,3	3200	7 x 20	
1000	VR25 820 b3	3m	M6	20 / 3,3	1	3,6	3200	9 x 27	
	VR5 1004 b2	2m	M5	4 / 0,7	2	0,45	1600	5 x 14	
	VR12 1008 b2	2m	M5	8 / 1,3	1	1,8	1600	7 x 20	
	VR12 1010 b1	1Am	M4	10 / 1,6	1	1,8	800	7 x 20	
	VR16 1012 b3	3m	M6	12,5 / 2	1	2,3	3200	7 x 20	
	VR25 1016 b3	3m	M6	16 / 2,6	1	3,6	3200	9 x 27	
	VR25 1020 b3	3m	M6	20 / 3,3	1	3,6	3200	9 x 27	
	VR12 1004 b3	3m	M6	4 / 0,7	2	1,8	3200	7 x 20	
	1250	VR12 1204 b1	1Am	M4	4 / 1,3	1	0,9	800	7 x 20
		VR12 1208 b1	1Am	M4	8 / 1,3	1	1,8	800	7 x 20
VR16 1232 b3		3m	M6	32 / 5	1	2,3	1600	9 x 27	
1600	VR5 1004 b2	2m	M5	4 / 0,7	2	1,8	1600	7 x 20	
	VR12 1604 b2	2m	M5	4 / 0,7	2	1,8	1600	7 x 20	
	VR12 1605 b2	2m	M5	5 / 0,8	2	1,8	1600	7 x 20	
	VR16 1608 b2	2m	M5	8 / 1,3	1	2,3	3200	9 x 27	
	VR25 1612 b3	3m	M6	12,5 / 2	1	3,6	3200	11,3x31	
2000	VR12 2004 b2	2m	M5	4 / 0,7	2	1,8	1600	7 x 20	
	VR12 2005 b1	1Am	M4	5 / 0,8	2	1,8	800	7 x 20	
	VR16 2006 b3	3m	M6	6,3 / 1	2	2,3	3200	9 x 27	
2500	VR25 2008 b3	3m	M6	8 / 1,3	1	3,6	3200	11,3 x 31	
	VR12 2504 b1	1Am	M4	4 / 0,7	2	3,6	800	7 x 20	
	VR16 2504 b3	3m	M6	4 / 0,7	2	2,3	3200	9 x 27	
3200	VR25 2508 b3	3m	M6	8 / 1,3	1	3,6	1600	11,3 x 31	
	VR16 3204 b2	2m	M5	4 / 0,7	2	2,3	1600	9 x 27	
4000	VR25 3206 b3	3m	M6	6,3 / 1	2	3,6	3200	11,3 x 31	
	VR25 4004 b3	3m	M6	4 / 0,7	2	3,6	3200	11,3 x 31	
5000	VR25 5004 b2	2m	M5	4 / 0,7	2	3,6	1600	11,3 x 31	
6300					nc			NEW	
7500					nc			NEW	
10000					nc			NEW	



Stagemaker SR10



Hoist according ATEX EX regulation



Stainless steel Hook and lifting chain

- Low speed trolley (3 to 10 m/min).
- Worm gear box.
- High speed trolley.
- Stainless steel wheels on trolley.
- Bigger flange width than 310m.
- Wall control box.
- IP 66 Protection.
- High capacity chain bag.
- Extra set of document.
- Special paint.
- Additional button on pendant.
- Direct voltage control instead of low voltage.
- Rain cover.
- Reinforced protection.
- Total protection zone 22.
- Tropicalised protection.
- Hoist according CSA specifications.
- Hoist according ATEX EX.
- Hoist for entertainment application (Stagemaker SR).

Lifting standards and rules

CE directive. Since 29th December 2009 a new Machine Directive (2006/42/CE) has been in application for the assembly and trade in new machines marketed from 2010. This new text completes the former Directive, which was a compilation of 600 standards from 1995. This directive requires manufacturers to harmonise their production according to certain provisions, standards, national rules and technical specifications.

F.E.M. European Federation of Handling Industries.

S.W.P. Safe Working Period. The unit's safe working period is determined according to the average usage time for the lifting mechanism, the load spectrum and the user group. After this period, a general overhaul recommended by the manufacturer is necessary.

User group. Depending on the FEM classification, two fundamental criteria must be taken into account: the use made of the hoist and the operating classes (related to the average daily usage time and the machine's lifting movement).

ISO standard. The usage groups may also be defined as ISO groups (1Am = M4, 2m = M5, 3m = M6, etc).

Usage conditions.

- **Light service.** Machine subject exceptionally to maximum use and frequently to very low use.
- **Medium service.** Machine subject quite often to maximum use and frequently to low use.
- **Heavy service.** Machine subject frequently to maximum use and frequently to medium use.
- **Very heavy service.** Machine subject regularly to use close to maximum use.

Average daily operating time in hours				≤ 0,5		≤ 1		≤ 2		≤ 4		≤ 8		≤ 16	
Operating class				V0,25	T2	V0,5	T3	V1	T4	V2	T5	V3	T6	V4	T7
Usage conditions	1	L1	Light					1Bm	M3	1Am	M4	2m	M5	V4	M6
	2	L2	Medium		1Bm	M3	1Am	M4	2m	M5	3m	M6			
	3	L3	Heavy	1Bm	M3	1Am	M4	2m	M5	3m	M6				
	4	L4	Very heavy	1Am	M4	2m	M5	3m	M6						
Group								1Bm	M3	1Am	M4	2m	M5	3m	M6
Operating factor*								25%		30%		40%		50%	
Number of start-ups per hour								150		180		240		300	

F.E.M. 9511 standard classification

ISO standard classification.

* Operating factor in % = $\frac{\text{Rise time} + \text{Lower time}}{\text{Rise time} + \text{Stop time} + \text{Lower time} + \text{Stop time}} \times 100$

VERLINDE EUROCHAIN VX

Electric chain hoist for loads from 63 to 10,000kg



Hoist Type	Dimensions (mm)			Weight w/o chain (kg)
	A	B	C	
EUROCHAIN VX2	387	297.6	141	22.5 (24.1*)
EUROCHAIN VX5	410	345.9	157	30 (35.3*)
EUROCHAIN VX10	483	417	196	53

Standard equipment

The electric chain hoist EUROCHAIN VX includes the following equipment as standard:

- Height of lift 3 m.
- Bracket suspension for suspended hoist.
- 2 hoisting speeds.
- Safety limit switch for upper & lower position.
- IP55 hoisting & travelling motor protection.
- Load chain galvanized.
- Control cable 2,5 m.
- 2 buttons pendant for hook suspended hoist or manual trolley.
- 4 buttons pendant for hoist with electric trolley.
- Power supply 400V/3Ph/50Hz or 415V/3Ph 50 Hz or 460V/3Ph /60 Hz.
- Low voltage control 48 V.
- Torque limiter.
- Chain collector.
- Emergency stop button mushroom type.
- Paint 5 years guaranteed (RAL 7021).
- Variable travelling speed (for hoist with electric trolley)
- 2 years guaranteed.



Options available

- Non standard power supply (ex.: 230 3ph).
- ACF board for direct control hoist.
- Hard wired control (48V).
- Stainless steel lifting chain and hook.
- Self locking hook.
- Time meter.
- Radio remote control.
- Pendant with 4 or 6 buttons.
- Key switch on pendant.
- Travel limit switches.

- Non standard length on power supply cable.
- Non standard power supply plug (4 or 5 poles).
- Rain cover.
- Brake manual release.
- Food contact oil (NSF H1).
- Gear limit switches 2 or 4 steps.

Available versions

- Fixed hoist suspended by bracket.
- Hoist on monorail push trolley.
- Hoist on monorail motorized trolley.

The EUROCHAIN VR hoist range

Load(kg)	Hoist type	Group (ISO)	Lifting speeds (m/min)	Reeving	Chain size
63	VX2 0608b3	M6	8/2	1	4.1 x 12.1
	VX2 0612b3	M6	12/3	1	4.1 x 12.1
	VX2 0616b3	M6	16/4	1	4.1 x 12.1
	VX2 0624b3	M6	24/6	1	4.1 x 12.1
125	VX2 1208b3	M6	8/2	1	4.1 x 12.1
	VX2 1212b3	M6	12/3	1	4.1 x 12.1
	VX2 1216b2	M5	16/4	1	4.1 x 12.1
160	VX2 1608b3	M6	8/2	1	4.1 x 12.1
	VX2 1612b3	M6	12/3	1	4.1 x 12.1
	VX5 1616b1	M4	16/4	1	5.1 x 15.1
	VX2 2508b2	M5	8/2	1	4.1 x 12.1
250	VX5 2512b1	M4	12/3	1	5.1 x 15.1
	VX5 2504b3	M6	4/1	1	5.1 x 15.1
	VX5 2508b3	M6	8/2	1	5.1 x 15.1
	VX5 2516b2	M5	16/4	1	5.1 x 15.1
320	VX5 3208b2	M5	8/2	1	5.1 x 15.1
	VX2 5004b2	M5	4 / 1	2	4,1 x 12,1
	VX5 5004b2	M5	4 / 1	1	5.1 x 15.1
500	VX5 5008b2	M5	8 / 2	1	5.1 x 15.1
	VX10 5012b2*	M5	12 / 3	1	7.2 x 21.1
	VX10 5004b2*	M5	4 / 1	1	7.2 x 21.1
	VX10 5008b3*	M6	8 / 2	1	7.2 x 21.1
630	VX10 5016b2*	M5	16 / 4	1	7.2 x 21.1
	VX5 6304b2	M5	4/1	2	5.1 x 15.1
	VX10 6316b1*	M4	16/4	1	7.2 x 21.1
	VX5 1004b2	M5	4/1	2	5.1 x 15.1
1000	VX10 1004b2*	M5	4/1	1	7.2 x 21.1
	VX10 1006b2*	M5	6/1,5	1	7.2 x 21.1
	VX10 1008b2*	M5	8/2	1	7.2 x 21.1
	VX10 1204b1*	M4	4/1	1	7.2 x 21.1
1250	VX10 1208b1*	M4	8/2	1	7.2 x 21.1
	VX10 1204b2*	M5	4/1	2	7.2 x 21.1
	VX10 1204b2*	M5	6/1,5	2	7.2 x 21.1
	VX10 1604b2*	M5	4/1	2	7.2 x 21.1
1600	VX10 1606b2*	M5	6/1,5	2	7.2 x 21.1
	VX10 2004b2*	M5	4/1	2	7.2 x 21.1
2000	VX10 2006b1*	M4	6/1,5	2	7.2 x 21.1
	VX10 2504b1*	M4	4/1	2	7.2 x 21.1

From 2,500 to 10,000kg consult us

VERLINDE EUROBLOC VT®

Electric wire rope hoist for load from 800 up to 80,000kg



Customised installations



Foot mounted.



Monorail trolley with standard headroom (HPN).



Monorail trolley with short headroom (HPR).



Double girder trolley high, medium and low version.



Monorail trolley with short headroom (HPR) and inverter on lifting motion (option).



Hoist according ATEX EX regulation

Options

- Non standard rail width.
- Special rail gauge.
- Higher travelling speed.
- Radio remote control.
- Travelling limit switch.
- Derailment catches on double girder trolley.
- Boogies trolley (only with HPN).
- Missing phase control.
- Monitor 2 (MT2).
- 2 or 3 steps overload device.
- Overload device temporization.
- Optical and audible warning connected to overload limit switch.
- Non standard main voltage.
- Rain cover.
- Klaxon on pendant box.
- Explosion proof and / or spark proof version.
- Load indication device.
- Motors thermal protection.
- Class H motors.
- Heating device on motor.
- Stainless steel hoist electrical cubicle IP 55 or IP 65.
- CSA electrical control.
- Hook operated upper limit switches.
- Ramshorn hook.
- Additional brake.
- Crash protection with electronic cell.

Standards and hoisting regulations

CE directive. Since December 2009, the European Machinery Directive (2006/42/EC) applies to the sale and assembly of all new machines marketed from 2010. The new decree is complementary to the former Directive, made up of 600 standards issued in 1995. That directive obliges that machine constructors ensure that their machinery complies with certain regulations, standards, national legislations and technical specifications.

F.E.M. European lifting equipment association.

S.W.P. Safe Working Period. A Safe Working Period is calculated for each electrical hoist unit according to the average operating time of the hoisting equipment, load capacity and class of application. After this period, a general service carried out by the constructor is necessary.

Class of operation. According to FEM classification, two fundamental criteria must be taken into account : the type of duty and the class of duty (according to average daily operation time average load).

ISO standard. Classes of operation can also be defined according to ISO grouping (1Am =M4, 2m =M5, 3m =M6, etc.).

Type of duty.

- **Light service.** Equipment rarely subject to maximum load and frequently to very little load.
- **Medium service.** Equipment rarely subject to maximum load and frequently to very little load.
- **Heavy service.** Equipment frequently subject to maximum load and frequently to medium load.
- **Very heavy service.** Equipment frequently subject to maximum or near maximum load.

Average daily operating time in hours				≤ 0,5		≤ 1		≤ 2		≤ 4		≤ 8		≤ 16	
Class of duty				V0,25	T2	V0,5	T3	V1	T4	V2	T5	V3	T6	V4	T7
Type of service	1	L1	Light					1Bm	M3	1Am	M4	2m	M5	V4	M6
	2	L2	Medium		1Bm	M3	1Am	M4	2m	M5	3m	M6			
	3	L3	Heavy	1Bm	M3	1Am	M4	2m	M5	3m	M6				
	4	L4	Very heavy	1Am	M4	2m	M5	3m	M6						
Group								1Bm	M3	1Am	M4	2m	M5	3m	M6
Operating factor*								25%	30%	40%	50%				
Number of start-ups per hour								150	180	240	300				

F.E.M. 9511 standard classification

ISO standard classification.

* Operating factor in % = $\frac{\text{Rise time} + \text{Lower time}}{\text{Rise time} + \text{Stop time} + \text{Lower time} + \text{Stop time}} \times 100$

The EUROCHAIN VR hoist range

*Not available in HPR version. **Consult us.

Hoist codification	Load (FEM/kg)			H.O.L.(m)	Lifting speeds (m/mn)	Trolleys					
	1Am	2m	3m			Fixed	Monorail		Double girder trolley		
							HPR	HPN	High	Med.	Low
VT10211--N P1		1 000	800	12	10 / 1,6	•	•	•	•	•	
VT10211--N P2		1 600	1 250	12 - 19	10 / 1,6	•	•	•	•	•	
VT10211--R P2		1 600	1 250	12 - 19	12,5 / 2	•	•	•	•	•	
VT10411--N P1		2 000	1 600	6 - 9,5	5 / 0,8	•	•	•	•	•	
VT10411--N P2		3 200	2 500	6 - 9,5	5 / 0,8	•	•	•	•	•	
VT10411--R P2		3 200	2 500	6 - 9,5	6,3 / 1	•	•	•	•	•	
VT20211--N P3		2 500	2 000	12 - 18 - 24 - 30*	10 / 1,6	•	•	•	•	•	
VT20211--R P4		2 500	2 000	12 - 18 - 24 - 30*	16 / 2,6	•	•	•	•	•	
VT20211--L P3	3 200			12 - 18 - 24 - 30*	8 / 1,3	•	•	•	•	•	
VT20411--N P3		5 000	4 000	6 - 9 - 12 - 15*	5 / 0,8	•	•	•	•	•	
VT20411--R P4		5 000	4 000	6 - 9 - 12 - 15*	8 / 1,3	•	•	•	•	•	
VT20411--L P3	6 300			6 - 9 - 12 - 15*	4 / 0,7	•	•	•	•	•	
VT20611--N P3		7 500		6 - 8 - 10	3,2 / 0,5	•	•	•	•	•	
VT20611--R P4		7 500		6 - 8 - 10	5 / 0,8	•	•	•	•	•	
VT20811--N P3	10 000	8 000		4,5 - 6 - 7,5	2,5 / 0,4	•	•	•	•	•	
VT20811--R P4	10 000	8 000		4,5 - 6 - 7,5	4 / 0,7	•	•	•	•	•	
VT30211--N P5		5 000	4 000	18 - 24 - 32 - 40*	10 / 1,6	•	•	•	•	•	
VT30211--R P6		5 000	4 000	18 - 24 - 32 - 40*	16 / 2,6	•	•	•	•	•	
VT30211--L P5	6 300			18 - 24 - 32 - 40*	8 / 1,3	•	•	•	•	•	
VT30411--N P5		10 000	8 000	9 - 12 - 16 - 20*	5 / 0,8	•	•	•	•	•	
VT30411--R P6		10 000	8 000	9 - 12 - 16 - 20*	8 / 1,3	•	•	•	•	•	
VT30411--L P5	12 500			9 - 12 - 16 - 20*	4 / 0,7	•	•	•	•	•	
VT30611--N P5		15 000		,5 - 6 - 8 - 10	3,2 / 0,5	•	•	•	•	•	
VT30611--R P6		15 000		4,5 - 6 - 8 - 10	5 / 0,8	•	•	•	•	•	
VT30811--N P5	20 000	16 000		4,5 - 6 - 8 - 10	2,5 / 0,4	•	•	•	•	•	
VT30811--R P6	20 000	16 000		4,5 - 6 - 8 - 10	4 / 0,7	•	•	•	•	•	
VT30421--N P5		5 000	4 000	10 - 14 - 19 - 26 - 35 - 47	10 / 1,6	•	•	•	•	•	
VT30421--R P6		5 000	4 000	10 - 14 - 19 - 26 - 35 - 47	16 / 2,6	•	•	•	•	•	
VT30821--N P5		10 000	8 000	5 - 7 - 9,5 - 13 - 17,5 - 23,5	5 / 0,8	•	•	•	•	•	
VT30821--R P6		10 000	8 000	5 - 7 - 9,5 - 13 - 17,5 - 23,5	8 / 1,3	•	•	•	•	•	
VT31221--N P5		15 000	12 000	4,5 - 6,5 - 8,5 - 11,5 - 15,5	3,2 / 0,5	•	•	•	•	•	
VT31221--R P6		15 000	12 000	4,5 - 6,5 - 8,5 - 11,5 - 15,5	5 / 0,8	•	•	•	•	•	
VT31621--N P5	20 000	16 000		4,5 - 6,5 - 8,5 - 11,5	2,5 / 0,4	•	•	•	•	•	
VT31621--R P6	20 000	16 000		4,5 - 6,5 - 8,5 - 11,5	4 / 0,7	•	•	•	•	•	
VT40211--L P6	10 000	8 000	6 300	16,4 - 22 - 28,6 - 37	8 / 1,3	•	•	•	•	•	
VT40211--N P6		8 000	6 300	16,4 - 22 - 28,6 - 37	10 / 1,6	•	•	•	•	•	
VT40211--R P7	10 000			16,4 - 22 - 28,6 - 37	10 / 1,6	•	•	•	•	•	
VT40211--R P7		8 000	6 300	16,4 - 22 - 28,6 - 37	12,5 / 2	•	•	•	•	•	
VT40411--L P6	20 000	16 000	12 500	8,2 - 11 - 14,3 - 18,5 - 23,8	4 / 0,6	•	•	•	•	•	
VT40411--N P6		16 000	12 500	8,2 - 11 - 14,3 - 18,5 - 23,8	5 / 0,8	•	•	•	•	•	
VT40411--R P7	20 000			8,2 - 11 - 14,3 - 18,5 - 23,8	5 / 0,8	•	•	•	•	•	
VT40411--R P7		16 000	12 500	8,2 - 11 - 14,3 - 18,5 - 23,8	6,3 / 1	•	•	•	•	•	
VT40611--L P6	30 000	25 000		5,5 - 7,3 - 9,5 - 12,3 - 15,9	2,5 / 0,4	•	•	•	•	•	
VT40611--N P6		25 000		5,5 - 7,3 - 9,5 - 12,3 - 15,9	3,2 / 0,5	•	•	•	•	•	
VT40611--R P7	30 000			5,5 - 7,3 - 9,5 - 12,3 - 15,9	3,2 / 0,5	•	•	•	•	•	
VT40611--R P7		25 000		5,5 - 7,3 - 9,5 - 12,3 - 15,9	4 / 0,6	•	•	•	•	•	
VT40811--L P6	40 000			5,8 - 7,2 - 9,3 - 11,9	2 / 0,3	•	•	•	•	•	
VT40811--R P7	40 000			5,8 - 7,2 - 9,3 - 11,9	2,5 / 0,4	•	•	•	•	•	
VT41011--N P7		1Bm / 50 000		5,8 - 7,2 - 9,3 - 11,9	2 / 0,3	•	•	•	•	•	
VT40421--L P6	10 000	8 000	6 300	20 - 25,7 - 33	8 / 1,3	•	•	•	•	•	
VT40421--N P6		8 000	6 300	20 - 25,7 - 33	10 / 1,6	•	•	•	•	•	
VT40421--R P7	10 000			20 - 25,7 - 33	10 / 1,6	•	•	•	•	•	
VT40421--R P7		8 000	6 300	20 - 25,7 - 33	12,5 / 2	•	•	•	•	•	
VT40821--L P6	20 000	16 000	12 500	10 - 12,8 - 16,5 - 21,2 - 27,9 - 33,7	4 / 0,6	•	•	•	•	•	
VT40821--N P6		16 000	12 500	10 - 12,8 - 16,5 - 21,2 - 27,9 - 33,7	5 / 0,8	•	•	•	•	•	
VT40821--R P7	20 000			10 - 12,8 - 16,5 - 21,2 - 27,9 - 33,7	5 / 0,8	•	•	•	•	•	
VT40821--R P7		16 000	12 500	10 - 12,8 - 16,5 - 21,2 - 27,9 - 33,7	6,3 / 1	•	•	•	•	•	
VT41221--L P6	30 000	25 000		6,6 - 8,5 - 11 - 14,1 - 18,6 - 22,4	2,5 / 0,4	•	•	•	•	•	
VT41221--N P6		25 000		6,6 - 8,5 - 11 - 14,1 - 18,6 - 22,4	3,2 / 0,5	•	•	•	•	•	
VT41221--R P7	30 000			6,6 - 8,5 - 11 - 14,1 - 18,6 - 22,4	3,2 / 0,5	•	•	•	•	•	
VT41221--R P7		25 000		6,6 - 8,5 - 11 - 14,1 - 18,6 - 22,4	4 / 0,6	•	•	•	•	•	
VT41621--L P6	40 000			6,4 - 8,2 - 10,6 - 13,9 - 16,8	2 / 0,3	•	•	•	•	•	
VT41621--R P7	40 000			6,4 - 8,2 - 10,6 - 13,9 - 16,8	2,5 / 0,4	•	•	•	•	•	
VT42021--N P7		1Bm / 50 000		6,6 - 8,5 - 11,1	2 / 0,3	•	•	•	•	•	
VT50421--	20 000	16 000	12 500	4,5 - 6,7 - 10,1 - 13,5	**	•	•	•	•	•	
VT50821--	40 000	32 000	25 000	6,2 - 8,2 - 10,9 - 14,4	**	•	•	•	•	•	
VT51221--	60 000	50 000		5,9 - 7,7 - 10 - 13,2	**	•	•	•	•	•	
VT51621--	80 000			5,8 - 7,5 - 9,9 - 12	**	•	•	•	•	•	

VERLINDE LIFTING EQUIPMENT **EUROLIFT BH®**



Options available

The EUROLIFT BH can be equipped with a great many options and can be specifically adapted for special purpose uses:

- Non standard beam section width.
- Higher travelling speeds.
- Time counter.
- EUROMOTE type infrared or radio remote-control.
- Travelling movement limit switch.
- Tropicalised travelling movement and lifting motors.
- Trolley mounted on bogies.
- Special power supply voltage.
- Load limiter with 2 or 3 steps.
- Total anti-corrosion protection*.
- Stainless steel hook and hook block**.
- Covering roof for protection against rain.
- Horn controlled from push button box.
- Explosion-proof hoist.

*Except BH5.
**Up to 2,5 T only. 3,2 T and 5 T stainless steel hook block, painted hook.

Standards and hoisting regulations

CE directive. Since 1st January 1995, the “EC” standard on machines 98/37/EEC, requires manufacturers of machines to harmonise their production to comply with certain provisions, standards, national rules of practice and technical specifications. Each VERLINDE unit bears the “EC” label and is delivered with an “EC” certificate of conformity (appendix IIA) or has a built-in certificate (appendix IIB).

F.E.M. The European Handling Equipment Federation.

S.W.P. Safe Working Period. The “Safe Working Period” of the hoisting unit is determined in terms of average type of use of the hoisting mechanism, load range and utilisation group. After this period has elapsed, the unit must undergo a the general overhaul as prescribed by the maker.

Class of operation. In accordance with FEM classification, two fundamental criteria must be allowed for: the level of load and stress of the hoist, and the operating categories (related to the average daily use and hoisting movement of the unit).

ISO standard. The utilisation groups can also be defined in terms of ISO groups (1Am = M4, 2m = M5, 3m = M6,...).

Type of duty.

- **Light service.** The unit is subjected to maximum loads only under exceptional circumstances, with very light loads the majority of the time.
- **Medium service.** The unit handles maximum loads fairly often, and frequently light loads.
- **Heavy service.** The unit is frequently subjected to maximum loads and normally to average loads.
- **Very heavy service.** The unit is regularly subjected to loads approaching the maximum.

Average daily operating time in hours				≤ 0,5		≤ 1		≤ 2		≤ 4		≤ 8		≤ 16	
Class of duty				V0,25	T2	V0,5	T3	V1	T4	V2	T5	V3	T6	V4	T7
Type of service	1	L1	Light					1Bm	M3	1Am	M4	2m	M5	V4	M6
	2	L2	Medium		1Bm	M3	1Am	M4	2m	M5	3m	M6			
	3	L3	Heavy	1Bm	M3	1Am	M4	2m	M5	3m	M6				
	4	L4	Very heavy	1Am	M4	2m	M5	3m	M6						
Group								1Bm	M3	1Am	M4	2m	M5	3m	M6
Duty factor**								25%		30%		40%		50%	
Number of start-ups per hour								150		180		240		300	

F.E.M. 9511 standard classification ISO standard classification.

* Operating factor in % = $\frac{\text{Hoisting time} + \text{Lowering time}}{\text{Hoisting time} + \text{Dwell time} + \text{Lowering time} + \text{Dwell}} \times 100$

Customised installations

Fixed version.



1. These hoists do not have a trolley and are designed for applications where no horizontal travel is needed.
Maximum capacity: 5,000kg.

Monorail short headroom hand-push travel trolley (HPR).



3. These hoists feature a trolley (for horizontal movement of the load) with a design enabling loads of up to 5,000kg to be moved with optimised hoisting height.

Monorail powered boggy trolley for curved beams.

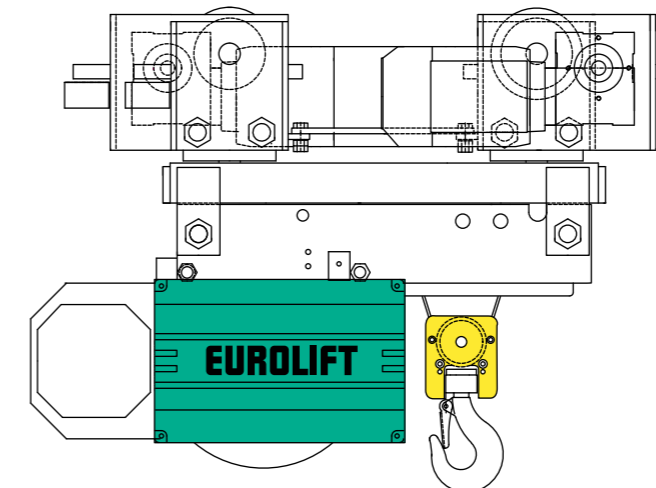

These hoists feature a trolley (for horizontal movement of the load) with a design enabling loads of up to 2,000kg to be moved horizontally on curved beams.

Monorail short headroom powered travel trolley (HPR).



2. These hoists feature a trolley (for moving the load in the horizontal direction) with a design enabling the user to make optimum use of the headroom and working area available for your job.
Maximum capacity: 2,000kg.

Monorail trolley into EUROSYSTEM profile.



4. These hoists feature a travelling trolley (for horizontal movement of the load). They are capable of lifting a load of up to 2,000kg and moving it horizontally in a straight or curved EUROSYSTEM profile.

EUROLIFT BH “Stainless steel” version.



Lifting of loads of up to 2,000kg with horizontal travel in an environment with high level of relative humidity.